

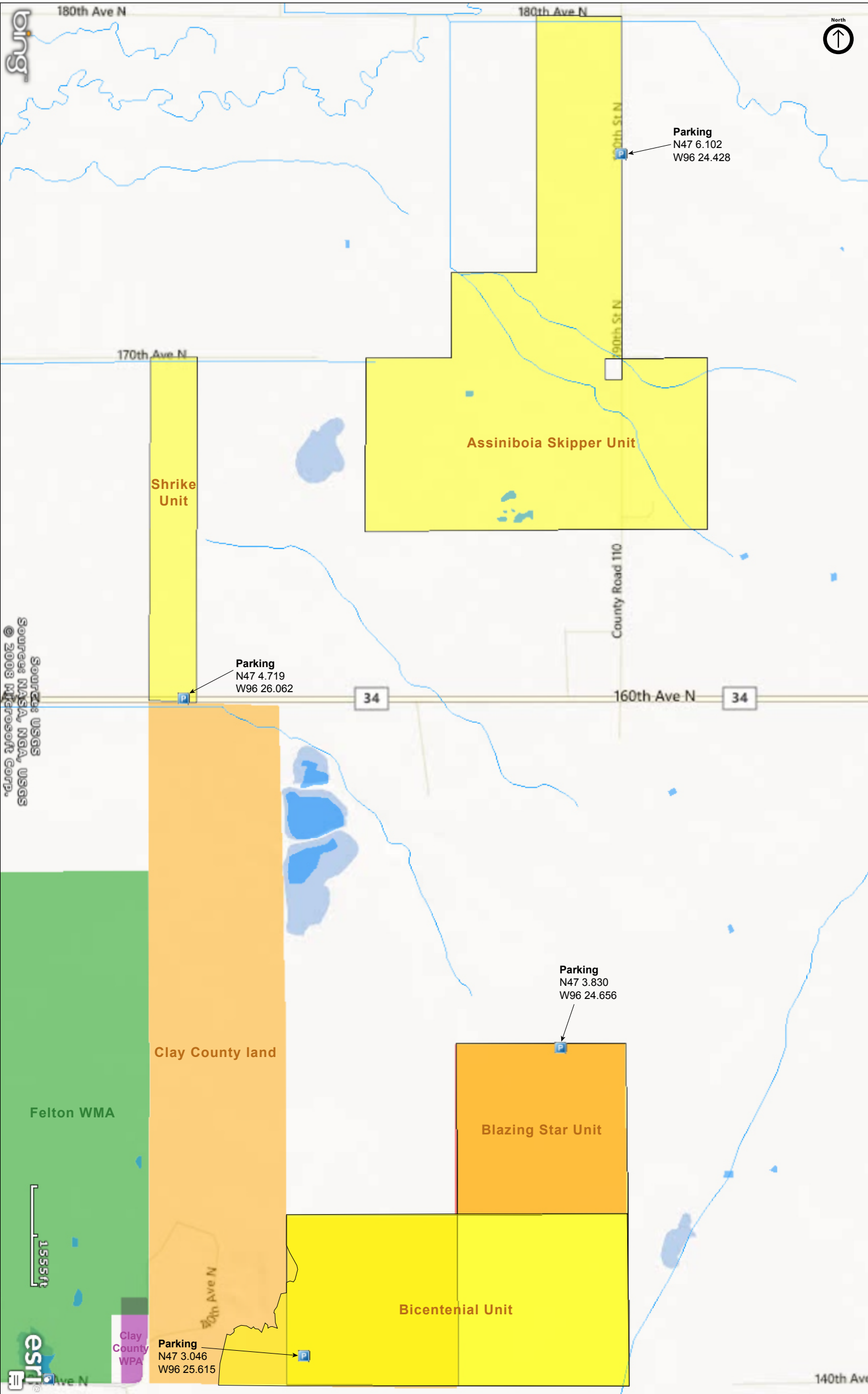

Felton Prairie SNA

Clay County



Felton Prairie SNA

Directions and Notes from Minnesota DNR

1) (Assiniboia Skipper Unit) From Felton 4.5 miles E on Co Hwy 34, then 1.6 miles N on Co Rd 110. Park on E road shoulder.

2) (Shrike Unit) From Felton 3 miles E on Co Hwy 34. Park in pull-off on N, near wood-routed sign.

3) (Bicentennial Unit) From Felton 2 miles S on MN Hwy 9, then 3 miles E on Co Rd 108. Continue on gravel road as it turns N, then E at fork, then in about 1,000 feet, as road turns N to gravel pit, look for field road on E, then E 1500 feet to parking.

This site has no maintained trails or other recreational facilities.

Notes from MinnesotaSeasons.com

Parking

Assiniboia Skipper Unit
N47 6.102, W96 24.428

Bicentennial Unit
N47 3.075, W96 25.777

Blazing Star Unit
N47 3.844, W96 24.654

Shrike Unit
N47 4.719, W96 26.062

DISCLAIMER OF WARRANTIES AND LIMITATIONS OF LIABILITY

MinnesotaSeasons.com, The Nature Conservancy, U.S. Department of Agriculture, Forest Service, U.S. Fish and Wildlife Service, the state of Minnesota, the Minnesota Department of Natural Resources, and their employees, make no representations or warranties, express or implied, with respect to the use of or reliance on the data provided herewith, regardless of its format or means of transmission. There are no guarantees or representations to the user as to the accuracy, currency, completeness, suitability or reliability of this data for any purpose. THE USER ACCEPTS THE DATA AND/OR SOFTWARE "AS IS" AND ASSUMES ALL RISKS ASSOCIATED WITH ITS USE.

IN NO EVENT SHALL MINNESOTASEASONS.COM, TNC, USDA-FS, USFWS, OR MNDNR BE LIABLE FOR ANY DIRECT, INDIRECT, INCIDENTAL, SPECIAL, EXEMPLARY, OR CONSEQUENTIAL DAMAGES (INCLUDING, BUT NOT LIMITED TO, PROCUREMENT OF SUBSTITUTE GOODS OR SERVICES; LOSS OF USE, DATA, OR PROFITS; OR BUSINESS INTERRUPTION) HOWEVER CAUSED AND ON ANY THEORY OF LIABILITY, WHETHER IN CONTRACT, STRICT LIABILITY, OR TORT (INCLUDING NEGLIGENCE OR OTHERS) ARISING IN ANY WAY OUT OF THE USE OF THIS DATA, EVEN IF ADVISED OF THE POSSIBILITY OF SUCH DAMAGE OR FOR ANY CLAIM BY ANY OTHER PARTY.

Your use of the data is acceptance on your part of the terms and conditions set forth herein.