

Glynn Prairie SNA

Lyon County



Source: Esri, DigitalGlobe, GeoEye, Earthstar Geographics, CNES/Airbus DS, USDA, USGS, AeroGRID, IGN, and the GIS User Community

Glynn Prairie SNA

Lyon County

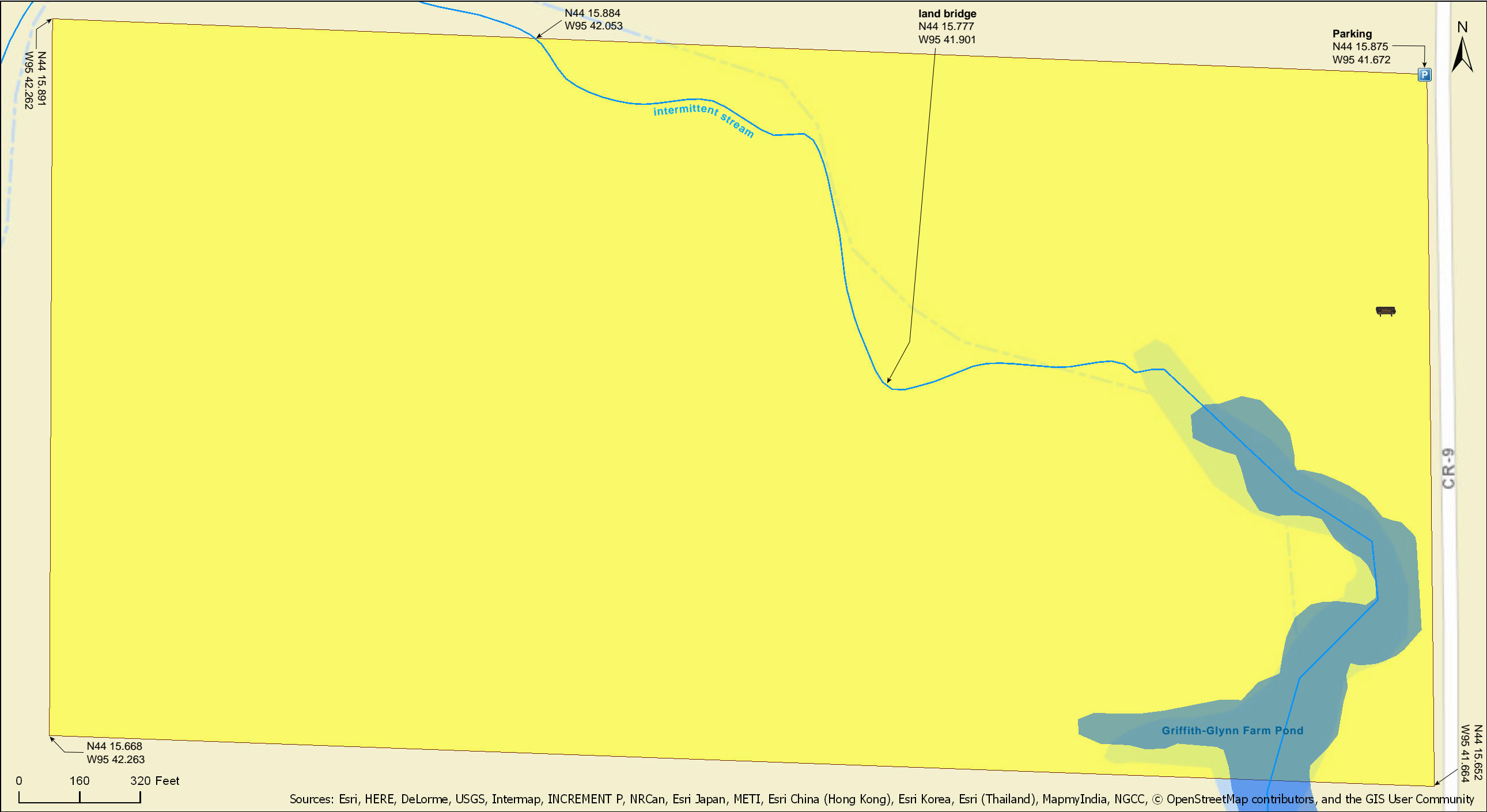



Glynn Prairie SNA

Lyon County



Glynn Prairie SNA

Lyon County

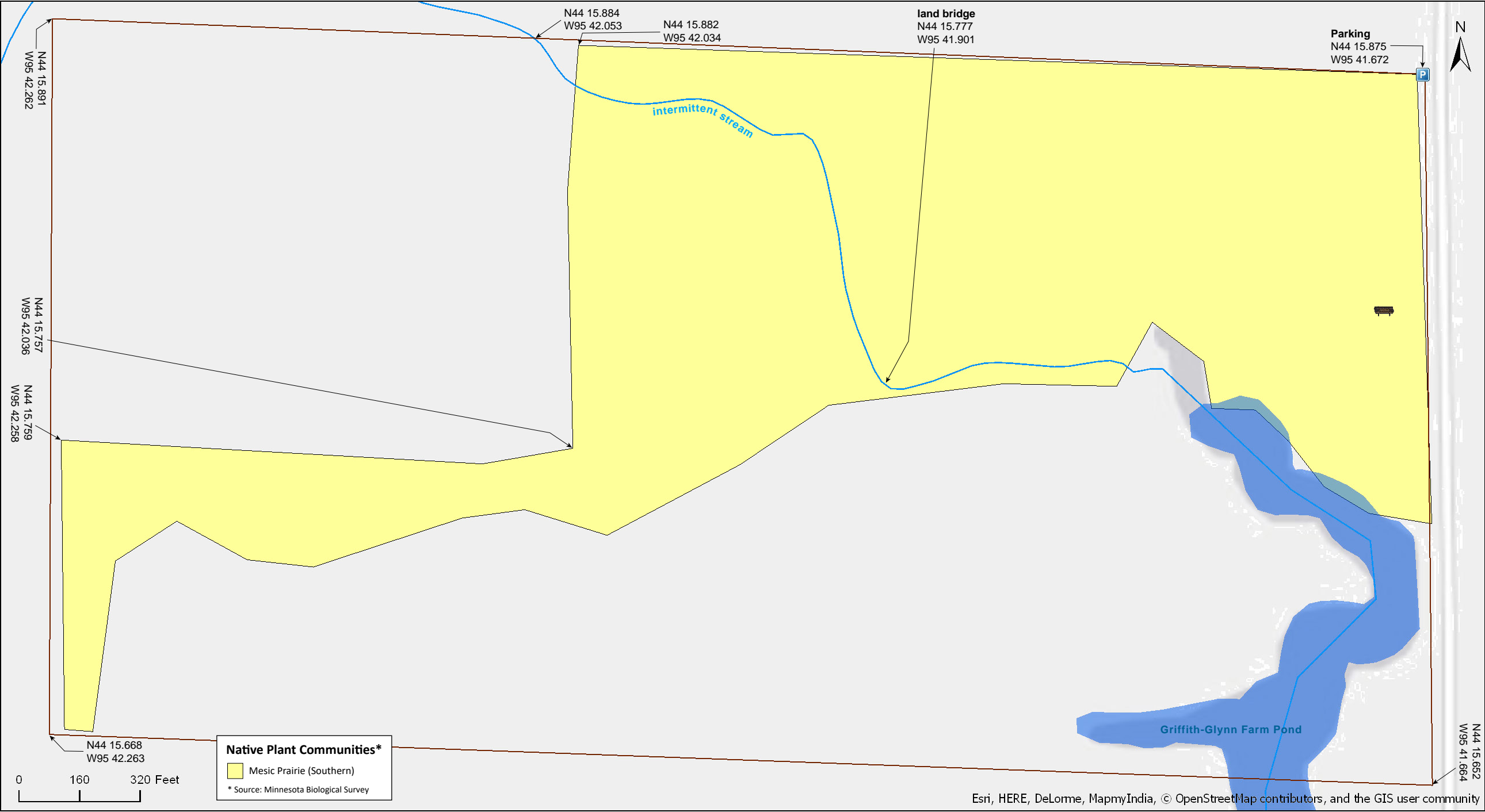

Esri, HERE, DeLorme, MapmyIndia, © OpenStreetMap contributors, and the GIS user community





Source: Esri, DigitalGlobe, GeoEye, Earthstar Geographics, CNES/Airbus DS, USDA, USGS, AeroGRID, IGN, and the GIS User Community

# Glynn Prairie SNA

## Directions and Notes from Minnesota DNR

**Directions:** From Tracy 3.5 miles W on US Hwy 14, then 1.75 miles N on Co Hwy 9. Park in pull-off on W.

**Lat/Lon:** 44.264515, -95.69446

This was one of more than 30 sites in eight states around the nation included in a recent (2013) study using genetic analysis to reconstruct microbial diversity of pre-agricultural tallgrass prairie soils-information intended to guide conservation efforts related to this fragmented ecosystem.

This site has no maintained trails or other recreational facilities.

## Notes from MinnesotaSeasons.com

### **Parking**

N44 15.875, W95 41.672

### **Intermittent Streams**

There are two intermittent streams on the site. The larger stream, labeled on the map, is shallow, wide, and often dry near the north boundary of the SNA. The smaller stream, not labelled but visible on the aerial map, is a deep but narrow gorge that can be easily hopped across near the western boundary of the SNA. Where the two streams meet there is a land bridge enabling an easy crossing.

## DISCLAIMER OF WARRANTIES AND LIMITATIONS OF LIABILITY

MinnesotaSeasons.com, The Nature Conservancy, U.S. Department of Agriculture, Forest Service, U.S. Fish and Wildlife Service, the state of Minnesota, the Minnesota Department of Natural Resources, and their employees, make no representations or warranties, express or implied, with respect to the use of or reliance on the data provided herewith, regardless of its format or means of transmission. There are no guarantees or representations to the user as to the accuracy, currency, completeness, suitability or reliability of this data for any purpose. THE USER ACCEPTS THE DATA AND/OR SOFTWARE "AS IS" AND ASSUMES ALL RISKS ASSOCIATED WITH ITS USE.

IN NO EVENT SHALL MINNESOTASEASONS.COM, TNC, USDA-FS, USFWS, OR MNDNR BE LIABLE FOR ANY DIRECT, INDIRECT, INCIDENTAL, SPECIAL, EXEMPLARY, OR CONSEQUENTIAL DAMAGES (INCLUDING, BUT NOT LIMITED TO, PROCUREMENT OF SUBSTITUTE GOODS OR SERVICES; LOSS OF USE, DATA, OR PROFITS; OR BUSINESS INTERRUPTION) HOWEVER CAUSED AND ON ANY THEORY OF LIABILITY, WHETHER IN CONTRACT, STRICT LIABILITY, OR TORT (INCLUDING NEGLIGENCE OR OTHERS) ARISING IN ANY WAY OUT OF THE USE OF THIS DATA, EVEN IF ADVISED OF THE POSSIBILITY OF SUCH DAMAGE OR FOR ANY CLAIM BY ANY OTHER PARTY.

Your use of the data is acceptance on your part of the terms and conditions set forth herein.