

Morton Outcrops SNA

Renville County



0 120 240 Feet

Source: Esri, DigitalGlobe, GeoEye, Earthstar Geographics, CNES/Airbus DS, USDA, USGS, AeroGRID, IGN, and the GIS User Community

Morton Outcrops SNA

Renville County

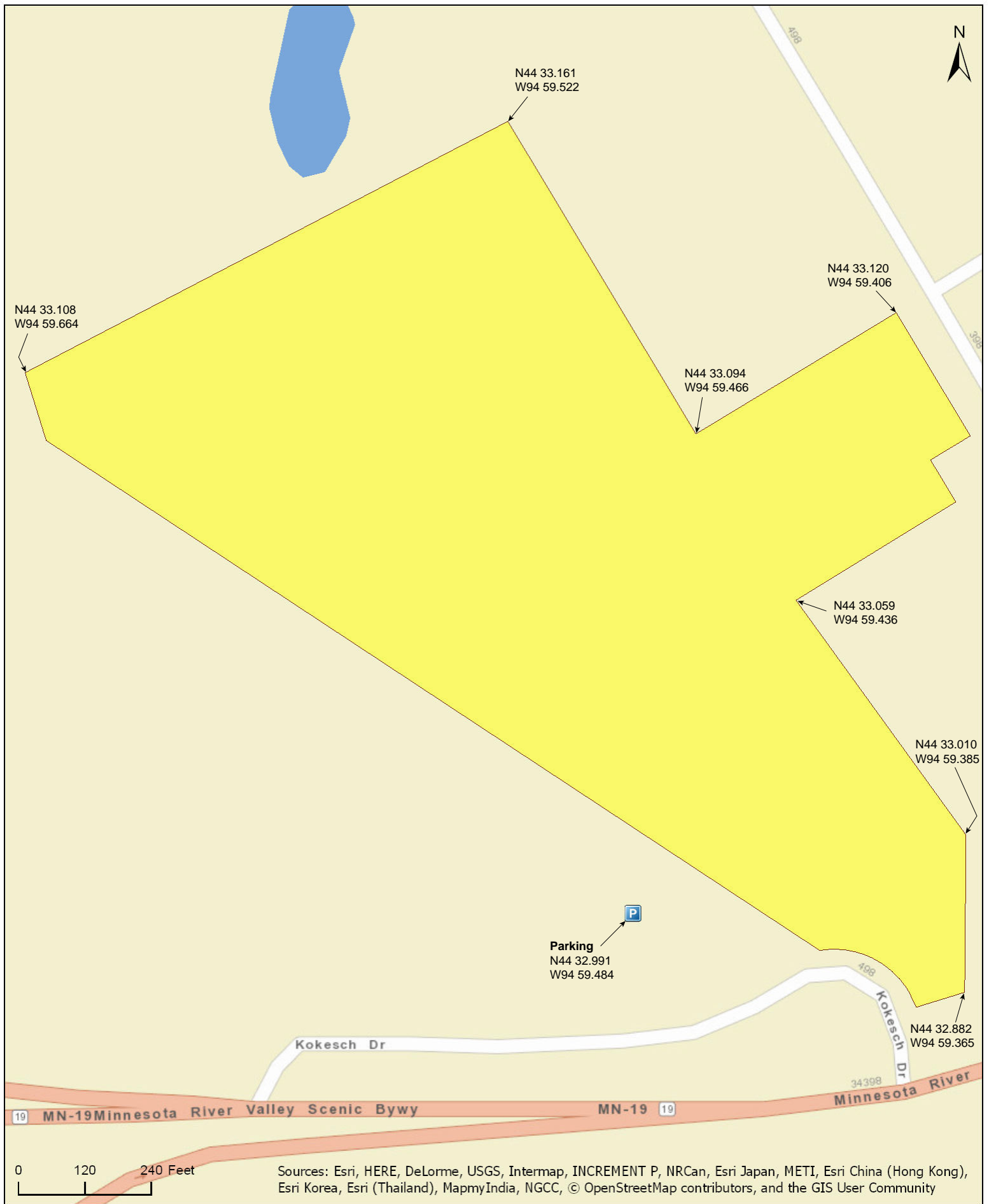

Morton Outcrops SNA

Renville County



Morton Outcrops SNA

Renville County

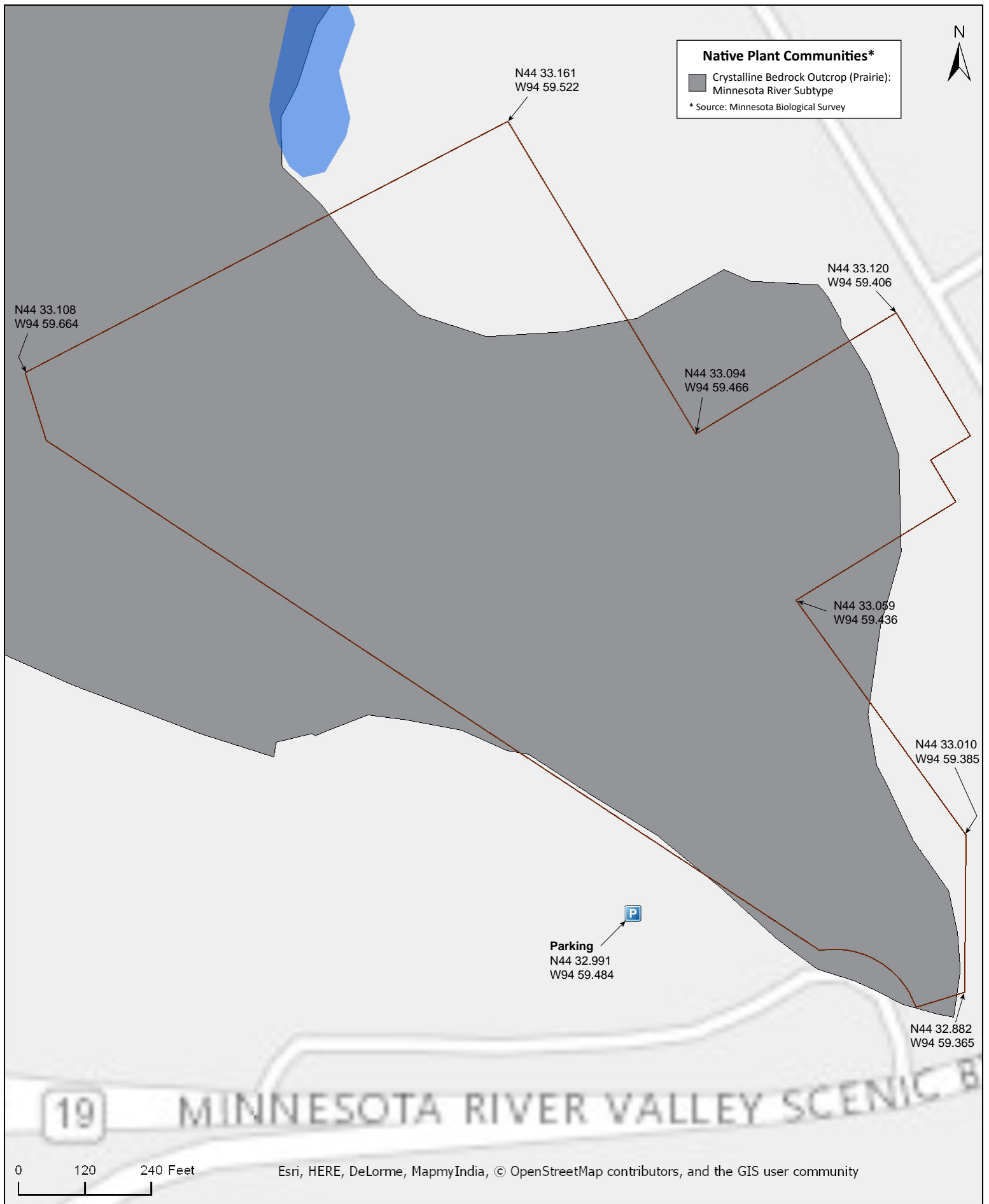



Morton Outcrops SNA

Directions and Notes from Minnesota DNR

Directions: In Morton, on NE corner of US Hwy 71 and MN Hwy 19. Ask permission to park at the gas station, then hike NE into site.

Lat/Lon: 44.549854, -94.991403

This site has no maintained trails or other recreational facilities.

Notes from MinnesotaSeasons.com

Parking

N44 32.991, W94 59.484

Ask permission at the BP station then park on the gravel drive/lot west of the site.

Hiking Trails

A short trail leads from the Hambdecka Trail sign to the nearest rock outcrop. The sign asks visitors to stay on the trail. However, the trail disappears at the first rock outcrop.

DISCLAIMER OF WARRANTIES AND LIMITATIONS OF LIABILITY

MinnesotaSeasons.com, The Nature Conservancy, U.S. Department of Agriculture, Forest Service, U.S. Fish and Wildlife Service, the state of Minnesota, the Minnesota Department of Natural Resources, and their employees, make no representations or warranties, express or implied, with respect to the use of or reliance on the data provided herewith, regardless of its format or means of transmission. There are no guarantees or representations to the user as to the accuracy, currency, completeness, suitability or reliability of this data for any purpose. THE USER ACCEPTS THE DATA AND/OR SOFTWARE "AS IS" AND ASSUMES ALL RISKS ASSOCIATED WITH ITS USE.

IN NO EVENT SHALL MINNESOTASEASONS.COM, TNC, USDA-FS, USFWS, OR MNDNR BE LIABLE FOR ANY DIRECT, INDIRECT, INCIDENTAL, SPECIAL, EXEMPLARY, OR CONSEQUENTIAL DAMAGES (INCLUDING, BUT NOT LIMITED TO, PROCUREMENT OF SUBSTITUTE GOODS OR SERVICES; LOSS OF USE, DATA, OR PROFITS; OR BUSINESS INTERRUPTION) HOWEVER CAUSED AND ON ANY THEORY OF LIABILITY, WHETHER IN CONTRACT, STRICT LIABILITY, OR TORT (INCLUDING NEGLIGENCE OR OTHERS) ARISING IN ANY WAY OUT OF THE USE OF THIS DATA, EVEN IF ADVISED OF THE POSSIBILITY OF SUCH DAMAGE OR FOR ANY CLAIM BY ANY OTHER PARTY.

Your use of the data is acceptance on your part of the terms and conditions set forth herein.