

Rice Lake Savanna SNA

Sherburne County



Rice Lake Savanna SNA

Sherburne County



Rice Lake Savanna SNA

Sherburne County



Rice Lake Savanna SNA

Sherburne County

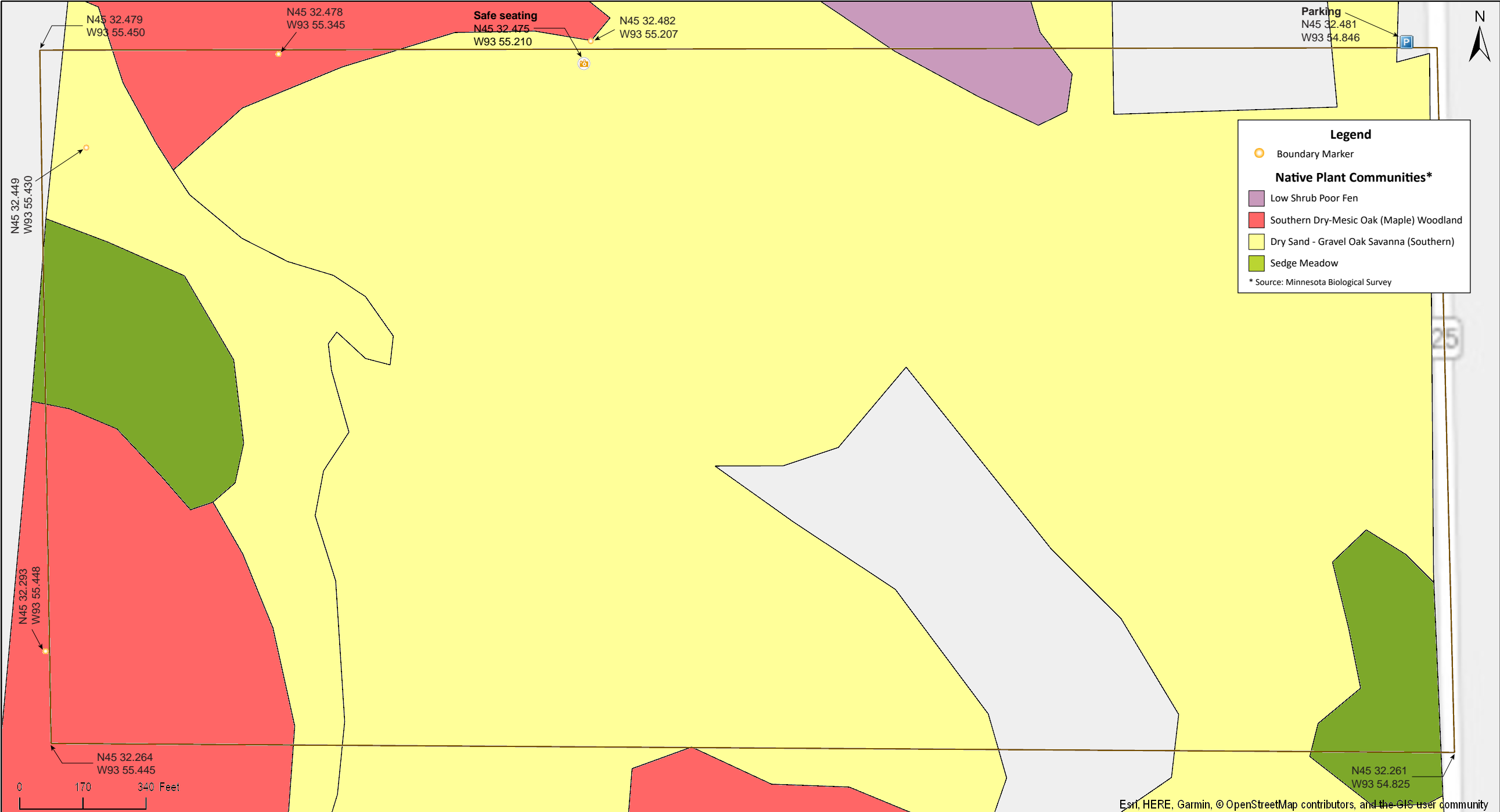



Rice Lake Savanna SNA

Directions and Notes from Minnesota DNR

Directions

From Becker 9.25 miles N on MN Hwy 25. Turn W at drive and park in pull-off on S at fork.

Lat/Lon

45.541354, -93.914099

This site has no maintained trails or other recreational facilities.

This site has abundant poison ivy.

Notes from MinnesotaSeasons.com

Getting There

This SNA is easy to miss even if you are looking for it. No wood-routed sign is visible from the road. About one mile north of Sherburne County Road 3 look to left (west) for two SNA boundary markers in an open area. They mark the southeast corner of the site. There is a shared driveway at the northeast corner of the site, and a pull-off on the south side of the shared driveway before the two driveways fork. Park on the pulloff.

Parking

N45 32.481, W93 54.846

DISCLAIMER OF WARRANTIES AND LIMITATIONS OF LIABILITY

MinnesotaSeasons.com, The Nature Conservancy, U.S. Department of Agriculture, Forest Service, U.S. Fish and Wildlife Service, the state of Minnesota, the Minnesota Department of Natural Resources, and their employees, make no representations or warranties, express or implied, with respect to the use of or reliance on the data provided herewith, regardless of its format or means of transmission. There are no guarantees or representations to the user as to the accuracy, currency, completeness, suitability or reliability of this data for any purpose. THE USER ACCEPTS THE DATA AND/OR SOFTWARE "AS IS" AND ASSUMES ALL RISKS ASSOCIATED WITH ITS USE.

IN NO EVENT SHALL MINNESOTASEASONS.COM, TNC, USDA-FS, USFWS, OR MNDNR BE LIABLE FOR ANY DIRECT, INDIRECT, INCIDENTAL, SPECIAL, EXEMPLARY, OR CONSEQUENTIAL DAMAGES (INCLUDING, BUT NOT LIMITED TO, PROCUREMENT OF SUBSTITUTE GOODS OR SERVICES; LOSS OF USE, DATA, OR PROFITS; OR BUSINESS INTERRUPTION) HOWEVER CAUSED AND ON ANY THEORY OF LIABILITY, WHETHER IN CONTRACT, STRICT LIABILITY, OR TORT (INCLUDING NEGLIGENCE OR OTHERS) ARISING IN ANY WAY OUT OF THE USE OF THIS DATA, EVEN IF ADVISED OF THE POSSIBILITY OF SUCH DAMAGE OR FOR ANY CLAIM BY ANY OTHER PARTY.

Your use of the data is acceptance on your part of the terms and conditions set forth herein.