

River Warren Outcrops SNA

Renville County



Source: Esri, DigitalGlobe, GeoEye, Earthstar Geographics, CNES/Airbus DS, USDA, USGS, AeroGRID, IGN, and the GIS User Community



River Warren Outcrops SNA

Renville County

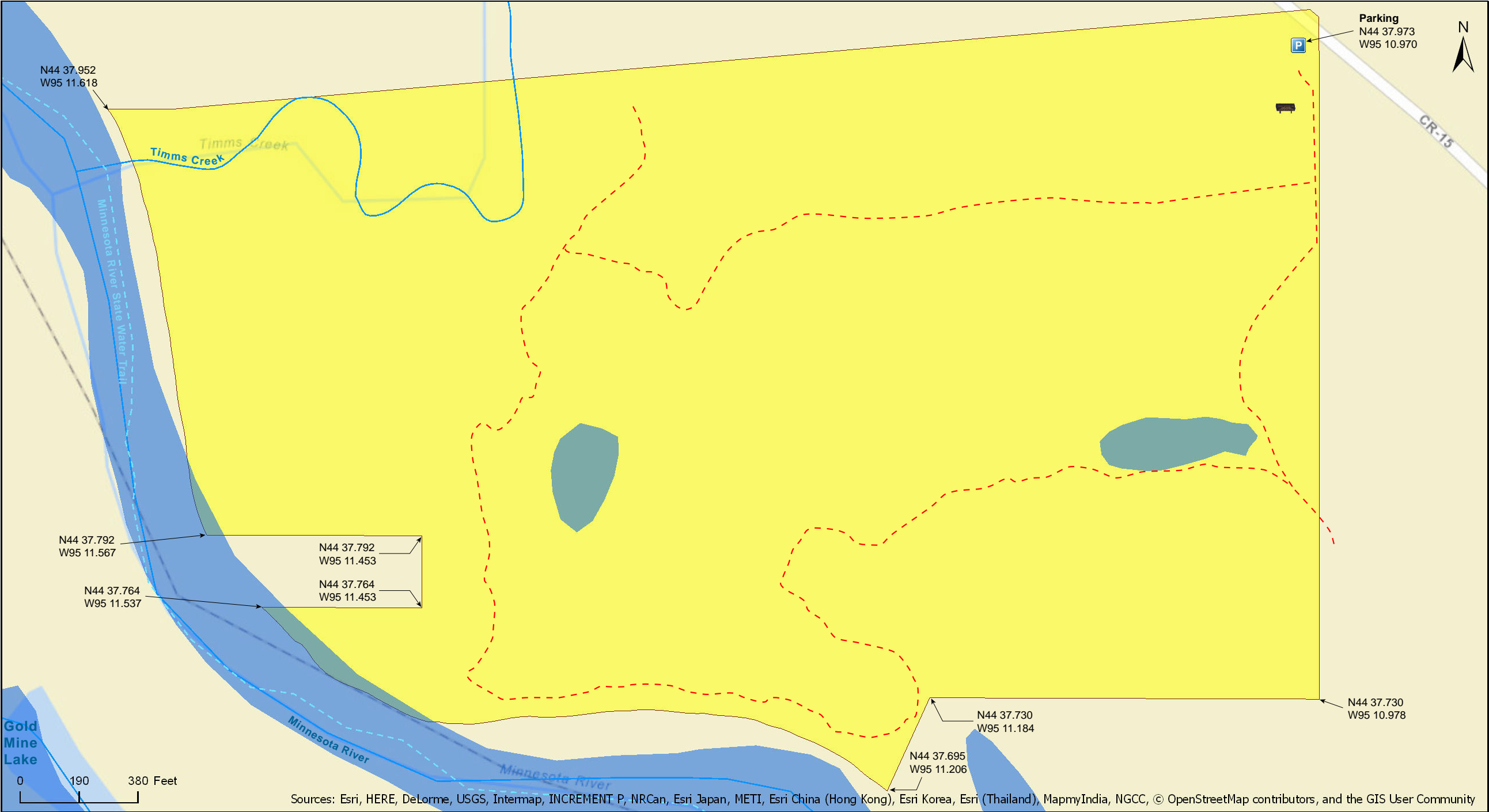

River Warren Outcrops SNA

Renville County





River Warren Outcrops SNA

Renville County

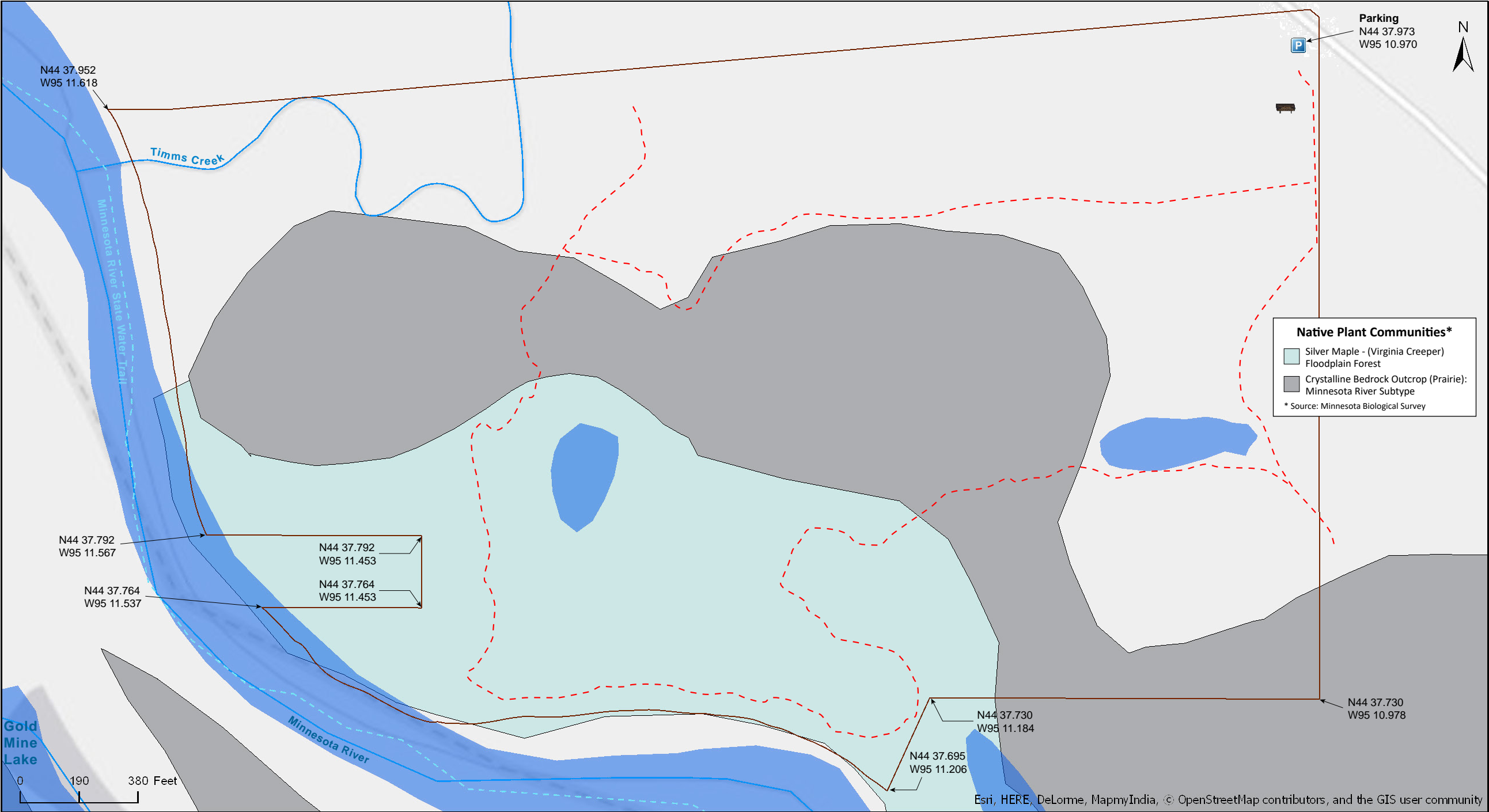







# River Warren Outcrops SNA

## Notes from Minnesota DNR

**Directions:** From Redwood Falls 1.5 miles W on MN 19, then 7.9 mile N on Co Hwy 17 (Co Hwy 21 after crossing Minnesota River), then W 0.4 miles on Co Rd 15. Park at pull-off and walk SW into site.

**Lat/Lon:** 44.632933, -95.183143

Horseback riding (only on trails and open seasonally May 15- October 15, when conditions allow).

Horse trails final alignments to be developed. Riders will be encouraged to reduce the introduction of invasive species. For example grooming prior to entering the SNA. This site is in an Audubon Important Bird Area.

Rock climbing for sport, including bouldering, is not allowed on Scientific and Natural Areas.

## Notes from MinnesotaSeasons.com

### **Parking**

N44 37.973, W95 10.970

## DISCLAIMER OF WARRANTIES AND LIMITATIONS OF LIABILITY

MinnesotaSeasons.com, The Nature Conservancy, U.S. Department of Agriculture, Forest Service, U.S. Fish and Wildlife Service, the state of Minnesota, the Minnesota Department of Natural Resources, and their employees, make no representations or warranties, express or implied, with respect to the use of or reliance on the data provided herewith, regardless of its format or means of transmission. There are no guarantees or representations to the user as to the accuracy, currency, completeness, suitability or reliability of this data for any purpose. THE USER ACCEPTS THE DATA AND/OR SOFTWARE "AS IS" AND ASSUMES ALL RISKS ASSOCIATED WITH ITS USE.

IN NO EVENT SHALL MINNESOTASEASONS.COM, TNC, USDA-FS, USFWS, OR MNDNR BE LIABLE FOR ANY DIRECT, INDIRECT, INCIDENTAL, SPECIAL, EXEMPLARY, OR CONSEQUENTIAL DAMAGES (INCLUDING, BUT NOT LIMITED TO, PROCUREMENT OF SUBSTITUTE GOODS OR SERVICES; LOSS OF USE, DATA, OR PROFITS; OR BUSINESS INTERRUPTION) HOWEVER CAUSED AND ON ANY THEORY OF LIABILITY, WHETHER IN CONTRACT, STRICT LIABILITY, OR TORT (INCLUDING NEGLIGENCE OR OTHERS) ARISING IN ANY WAY OUT OF THE USE OF THIS DATA, EVEN IF ADVISED OF THE POSSIBILITY OF SUCH DAMAGE OR FOR ANY CLAIM BY ANY OTHER PARTY.

Your use of the data is acceptance on your part of the terms and conditions set forth herein.