

# Shooting Star Prairie SNA

Mower County



Source: Esri, DigitalGlobe, GeoEye, Earthstar Geographics, CNES/Airbus DS, USDA, USGS, AeroGRID, IGN, and the GIS User Community

# Shooting Star Prairie SNA

Mower County

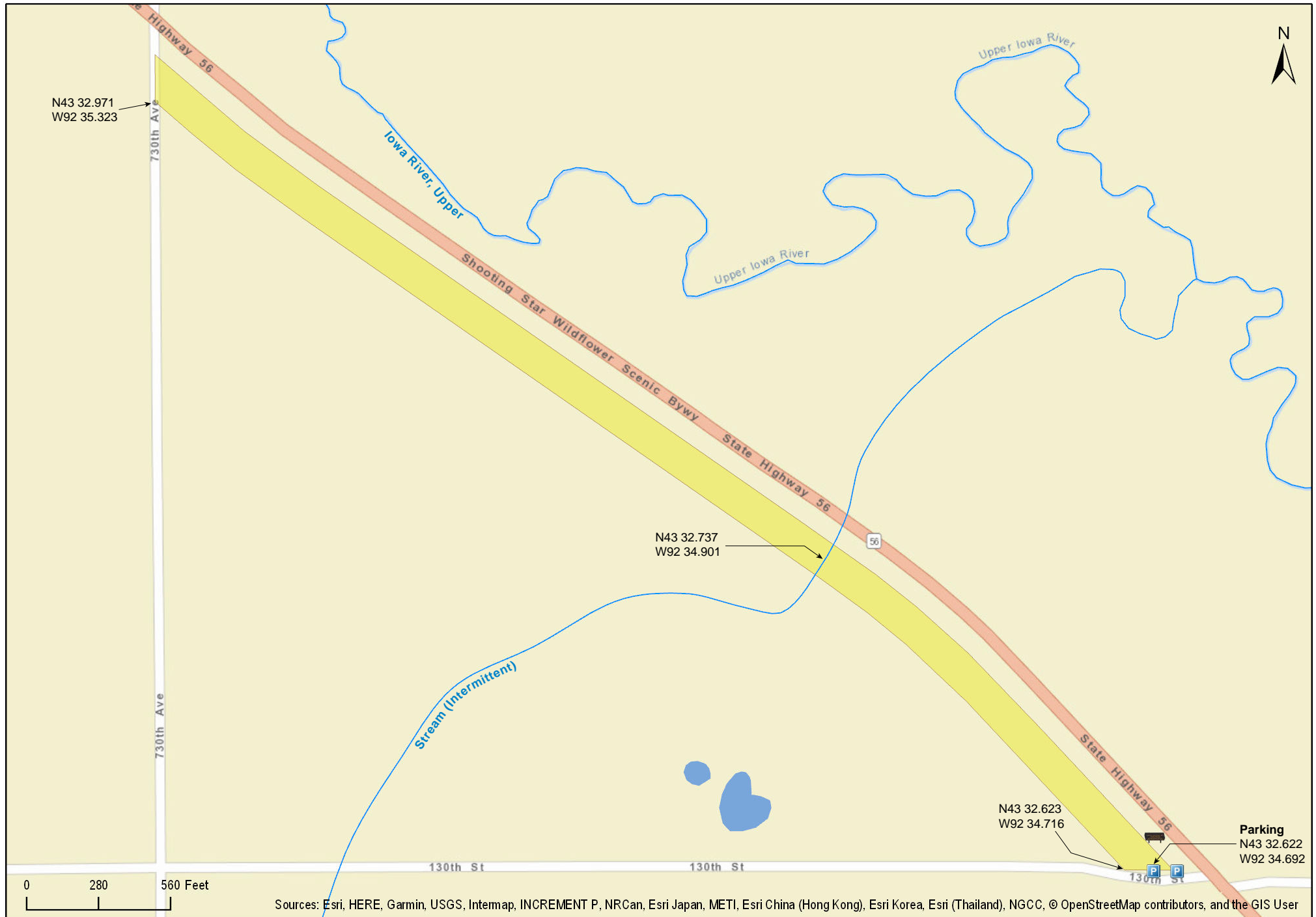



# Shooting Star Prairie SNA

Mower County



# Shooting Star Prairie SNA

Mower County







# Shooting Star Prairie SNA

## **Directions and Notes from Minnesota DNR**

**Directions:** From Leroy 4.5 miles NW on MN Hwy 56. Turn W at 130th St and park on N road shoulder.

**Lat/Lon:** 43.543692, -92.577943

This site has no maintained trails or other recreational facilities.

## **Notes from MinnesotaSeasons.com**

### **Parking**

N43 32.622, W92 34.692

There is a ditch crossing/field access over a culvert on 130th Street 120 feet west of the intersection. Pull off the road and park over the culvert. There is room for two vehicles.

### **High Quality Prairie**

Visitors to this site shouldn't just walk the old railbed. The area between the rail bed and County Road 8 is high quality mesic prairie.

## **DISCLAIMER OF WARRANTIES AND LIMITATIONS OF LIABILITY**

MinnesotaSeasons.com, The Nature Conservancy, U.S. Department of Agriculture, Forest Service, U.S. Fish and Wildlife Service, the state of Minnesota, the Minnesota Department of Natural Resources, and their employees, make no representations or warranties, express or implied, with respect to the use of or reliance on the data provided herewith, regardless of its format or means of transmission. There are no guarantees or representations to the user as to the accuracy, currency, completeness, suitability or reliability of this data for any purpose. THE USER ACCEPTS THE DATA AND/OR SOFTWARE "AS IS" AND ASSUMES ALL RISKS ASSOCIATED WITH ITS USE.

IN NO EVENT SHALL MINNESOTASEASONS.COM, TNC, USDA-FS, USFWS, OR MNDNR BE LIABLE FOR ANY DIRECT, INDIRECT, INCIDENTAL, SPECIAL, EXEMPLARY, OR CONSEQUENTIAL DAMAGES (INCLUDING, BUT NOT LIMITED TO, PROCUREMENT OF SUBSTITUTE GOODS OR SERVICES; LOSS OF USE, DATA, OR PROFITS; OR BUSINESS INTERRUPTION) HOWEVER CAUSED AND ON ANY THEORY OF LIABILITY, WHETHER IN CONTRACT, STRICT LIABILITY, OR TORT (INCLUDING NEGLIGENCE OR OTHERS) ARISING IN ANY WAY OUT OF THE USE OF THIS DATA, EVEN IF ADVISED OF THE POSSIBILITY OF SUCH DAMAGE OR FOR ANY CLAIM BY ANY OTHER PARTY.

Your use of the data is acceptance on your part of the terms and conditions set forth herein.