

Lost River Peatland SNA Southeast Unit Approach

Koochiching County



Lost River Peatland SNA Southeast Unit Approach

Koochiching County

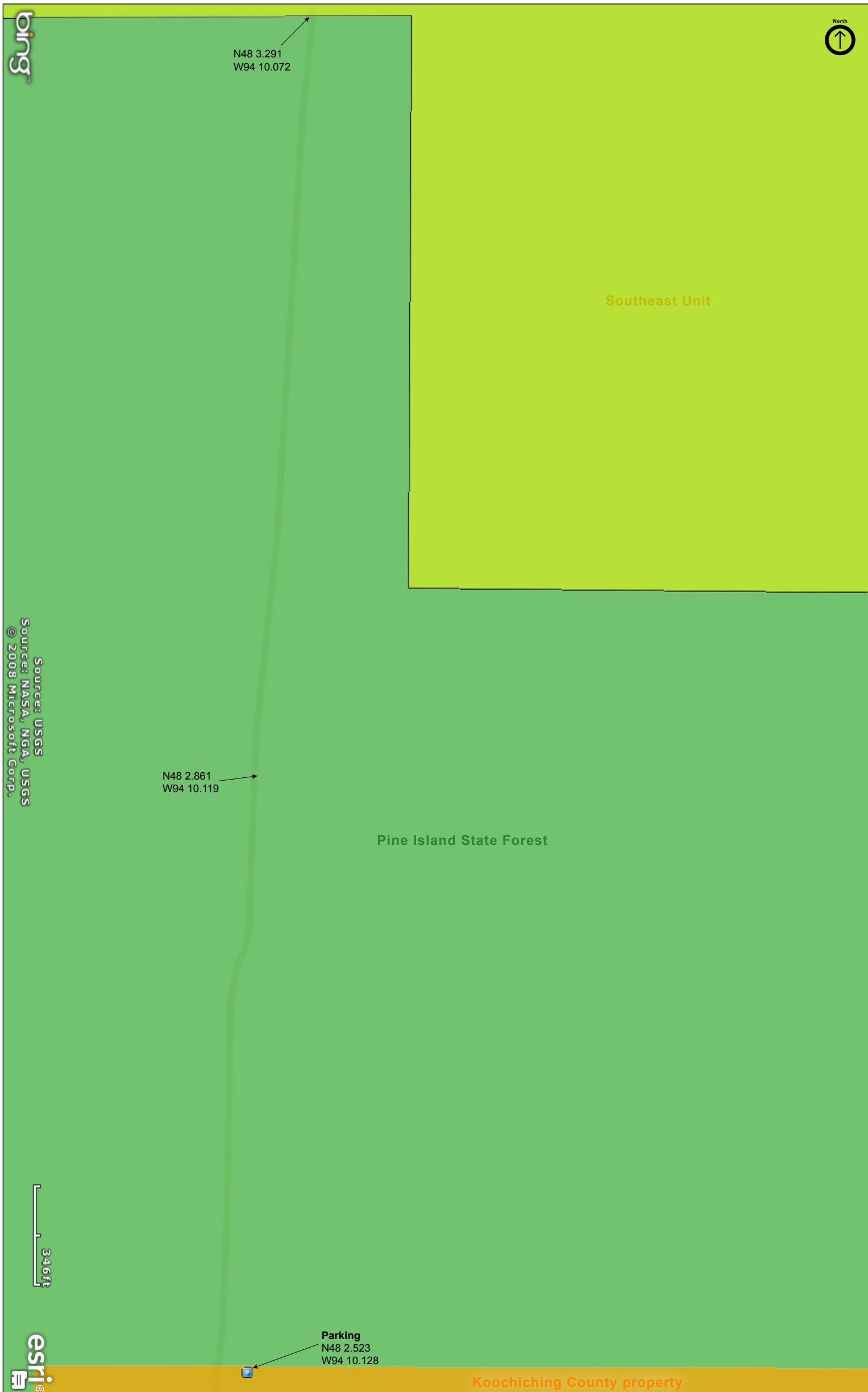

Lost River Peatland SNA Southeast Unit Approach

Directions and Notes from Minnesota DNR

From Big Falls 17 miles SW on US Hwy 71, then 3 miles NW on W Gemmel Forest Rd, then 3.25 miles NW on Lost River Forest Rd (last 1.25 miles are minimum maintenance). Park and trek 1 mile N into site. GPS recommended.

A GPS and detailed topographical maps are advised to visit this site.

This site has no maintained trails or other recreational facilities.

This site is within the Pine Island State Forest.

Notes from MinnesotaSeasons.com

Parking

N48 2.523, W94 10.128

Winter Road

The easiest access to the both units is via winter trails, shown on the topographical map. Unfortunately, most winter trails are impassible in the summer.

DISCLAIMER OF WARRANTIES AND LIMITATIONS OF LIABILITY

MinnesotaSeasons.com, The Nature Conservancy, U.S. Department of Agriculture, Forest Service, U.S. Fish and Wildlife Service, the state of Minnesota, the Minnesota Department of Natural Resources, and their employees, make no representations or warranties, express or implied, with respect to the use of or reliance on the data provided herewith, regardless of its format or means of transmission. There are no guarantees or representations to the user as to the accuracy, currency, completeness, suitability or reliability of this data for any purpose. THE USER ACCEPTS THE DATA AND/OR SOFTWARE "AS IS" AND ASSUMES ALL RISKS ASSOCIATED WITH ITS USE.

IN NO EVENT SHALL MINNESOTASEASONS.COM, TNC, USDA-FS, USFWS, OR MNDNR BE LIABLE FOR ANY DIRECT, INDIRECT, INCIDENTAL, SPECIAL, EXEMPLARY, OR CONSEQUENTIAL DAMAGES (INCLUDING, BUT NOT LIMITED TO, PROCUREMENT OF SUBSTITUTE GOODS OR SERVICES; LOSS OF USE, DATA, OR PROFITS; OR BUSINESS INTERRUPTION) HOWEVER CAUSED AND ON ANY THEORY OF LIABILITY, WHETHER IN CONTRACT, STRICT LIABILITY, OR TORT (INCLUDING NEGLIGENCE OR OTHERS) ARISING IN ANY WAY OUT OF THE USE OF THIS DATA, EVEN IF ADVISED OF THE POSSIBILITY OF SUCH DAMAGE OR FOR ANY CLAIM BY ANY OTHER PARTY.

Your use of the data is acceptance on your part of the terms and conditions set forth herein.